

Pluro Single Lever

abode

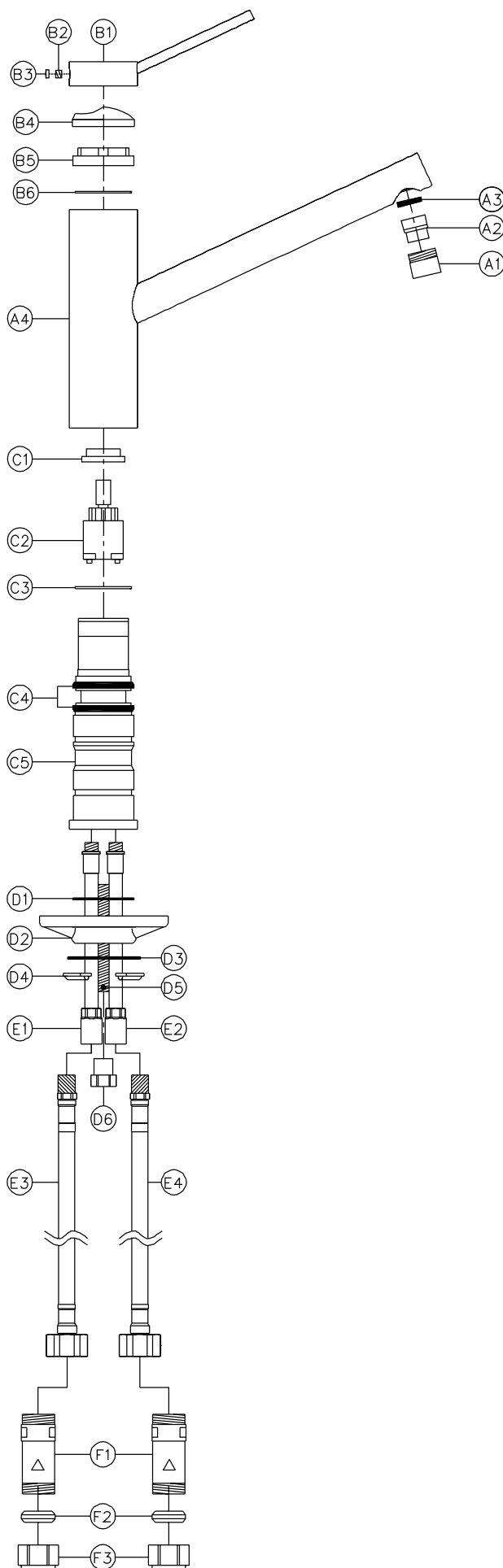

Pluro Single Lever

abode

General Advice:

- These instructions are intended as a guide only, if you are in any doubt you should seek the advice of a qualified professional.
- Take care not to mark finished parts with screwdrivers or other tools.
- Use a pair of rubber gloves to get a better grip on decorative hand tight parts.
- Ensure all parts are reassembled tightly.
- After maintenance test that all assemblies are water tight and function correctly.
- Always isolate the hot and cold water supplies before starting any maintenance, once isolated you should drain any residual water from your system.

To replace the hot and cold valve:

1. Remove cap (B3) horizontally from handle (B1).
2. Loosen grub screw (B2) on the side of handle (B1) using a 2.5mm A/F allen key.
3. Pull the handle (B1) vertically away from the tap body (A4).
4. Pull the valve cover (B4) vertically away from tap body (A4) by hand.
5. Hold the body of the tap (A4) firmly. Using an adjustable spanner unscrew the inner body lock nut (B5).
6. Pull tap body (A4) vertically away from inner body (C5) separating the two bodies.
7. Hold the inner body (C5) firmly. Using an adjustable spanner unscrew the valve lock nut (C1).
8. Clean the Inside of chamber (C5) with a soft wet cloth.
9. Reassemble the tap in the reverse order replacing valve (C2).

To replace the spout o-rings:

1. Follow steps 1 – 6 from above instruction.
2. Remove the old o-rings (C4) using a small screwdriver or similar.
3. If worn, remove the white PTFE spacer (C3).
4. Ensure the outside of the body (C5) and the inside of the spout body (A4) is clean of dirt and grit with a soft wet cloth.
5. Carefully locate the new O-rings (C4) onto the inner body (C5).
6. Grease the O-rings thoroughly with silicone or alternative similar grease.
7. Reassemble the tap in the reverse order.